

Procedure 7.2 - Replacing the Display Enclosure or Upper PCA (version 1)

Anti-static kits (part number 20024-101) can be ordered from Precor.

Removing the Display Enclosure

1. Set the on/off switch in the *off* position.

WARNING

Before continuing with this procedure, review the Warning and Caution statements listed in Section One, Things You Should Know.

2. Remove the screws that secure the interconnect cable cover to the bottom of the display backing plate. Remove the interconnect cover cable. See Diagram 7.4.
3. Remove the screws that secure the reading rack to the display backing plate. Remove the reading rack.
4. Remove the screws that secure the display housing to the display backing plate.
5. Attach the wrist strap to your arm, then connect the ground lead of the wrist strap to the EFX frame.
6. Disconnect the interconnect cable from the upper PCA.
7. If you are going to re-install the display enclosure without replacing the upper PCA...

THEN...

Skip to Step 10.

OTHERWISE...

Continue with the next step.

Removing and Replacing the Upper PCA

8. Carefully disconnect the keypad cable from the upper PCA.
9. Remove the screws that secure the upper PCA to the display enclosure.

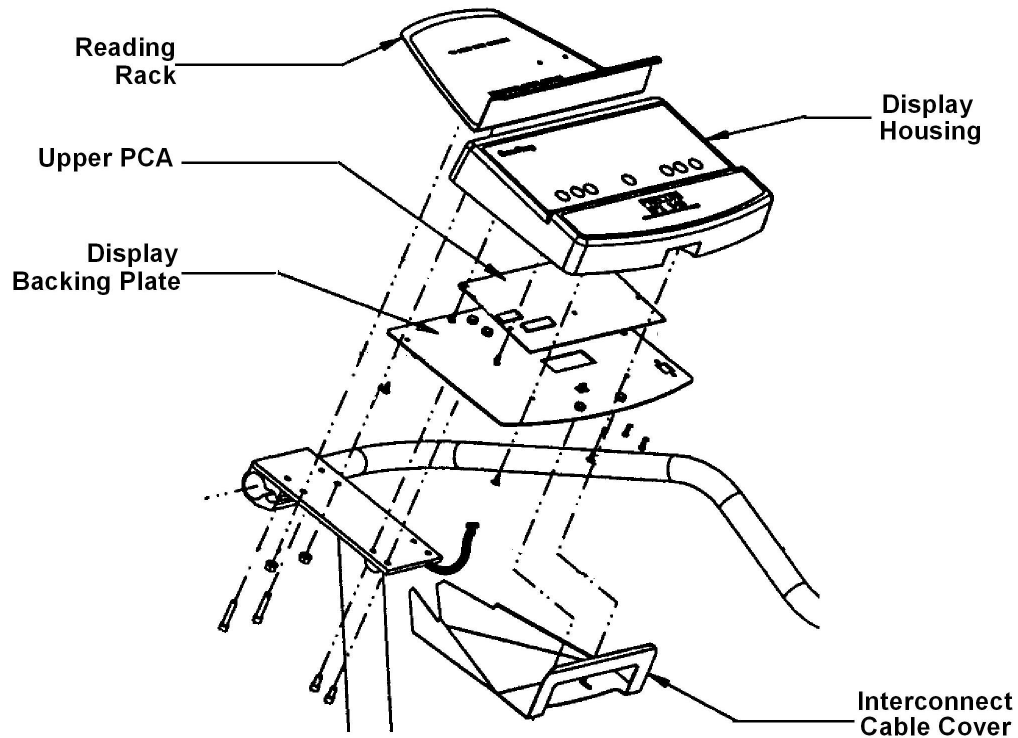
Diagram 7.4 - Upper Handlebar Assembly

10. Reposition the upper PCA at its mounting location on the display enclosure (refer to Diagram 7.4). Replace and tighten the upper PCA mounting screws.
11. Reconnect the keypad cable to the upper PCA.
12. Reconnect the interconnect cable to the upper PCA.
13. Remove the ground lead of the wrist strap from the EFX frame, then remove the wrist strap from your arm.
14. Position the display enclosure on the display plate. Replace and tighten the display mounting screws.
15. Reposition the reading rack, replace and tighten the reading rack mounting screws.
16. Reposition the interconnect cable cover, replace and tighten the interconnect cable cover mounting screws.
17. Check operation as described in Section Four.